

REVISIONS				
REV.	DESCRIPTION	ECO #	DATE	APPROVED
A1	RELEASE	2017-054	6/12/2017	CMB

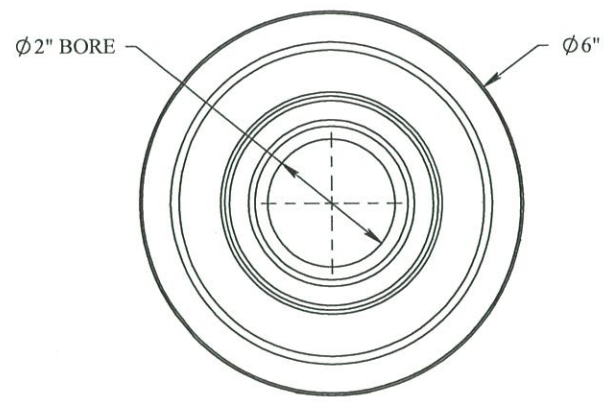

ACCESSORIES		
PART NO.	DESCRIPTION	QTY.
SE-1112	GREASE, SYNTHETIC, INDUSTRIAL, LC 2, NLGI GRADE 1.5	14 oz.
SE-1015	RING GASKET, 2 1/16", BX152	2

SPARE PARTS		
PART NO.	DESCRIPTION	QTY.
TSC-02348-SK	KIT, SEAL	1
TSC-02348-BK	KIT, BALL BEARING	1

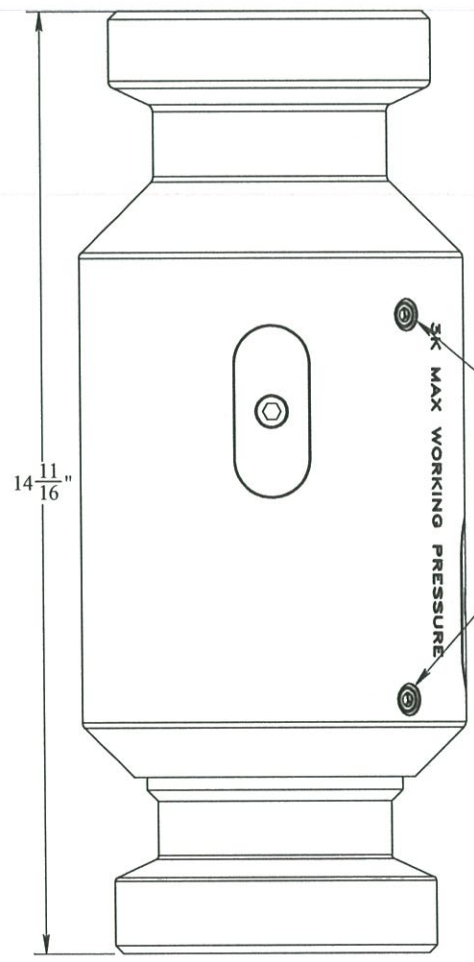

GREASE PORTS

BALL BEARING
KEEPERS

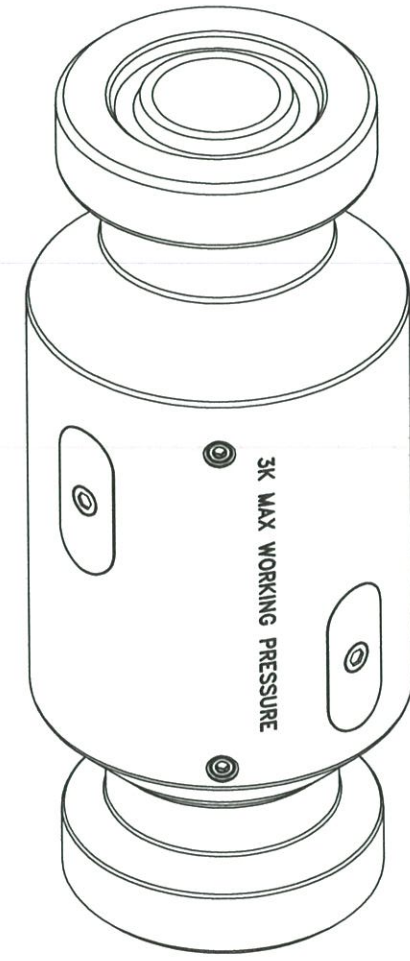
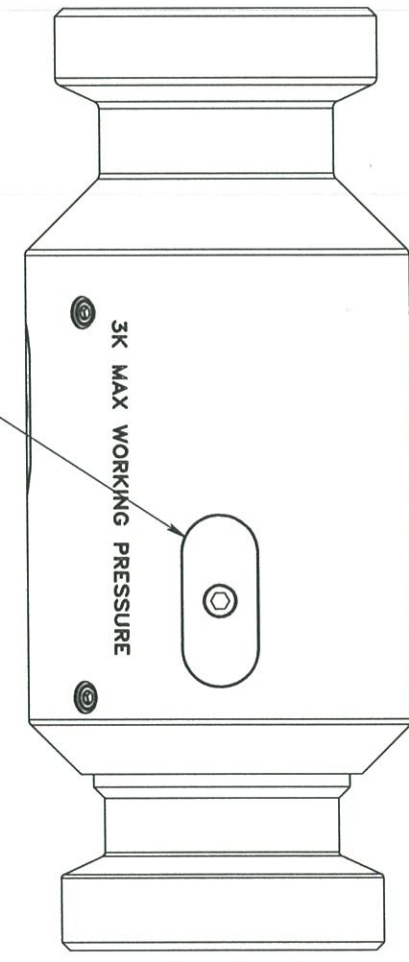

- NOTES:
1. WORKING PRESSURE - 3K PSI MAX.
 2. TESTED AT 1.5 TIMES WORKING PRESSURE
 3. 2-1/16" API 16A TYPE 16BX HUB - BX-152 RING GROOVE, USES #1 CLAMP
 4. CORROSION RESISTANT SEAL AREAS.
 5. TWO REMOVABLE PLUGS TO ACCESS GREASE PORTS.
 6. WEIGHT: 74 LBS.
 7. STANDARDS AND REGULATIONS NACE MR0175

PROPRIETARY AND CONFIDENTIAL: THE INFORMATION CONTAINED IN THIS DRAWING IS THE SOLE PROPERTY OF THE SUBSEA COMPANY INC. ANY REPRODUCTION IN PART OR AS A WHOLE WITHOUT THE WRITTEN PERMISSION OF THE SUBSEA COMPANY INC IS PROHIBITED.	WORKMANSHIP STANDARD PER WI 751-001	DRAWN: GREG 6-15-17 CHECKED: [Signature] 6-15-17 APPROVED: [Signature] 6-16-17	THE SUBSEA COMPANY INC
	UNLESS OTHERWISE SPECIFIED: ALL DIMENSIONS ARE IN INCHES	SIZE: B TITLE: SWIVEL, LC, 2-1/16" API 16A 5K HUBS, BX-152, 3K MAWP DWG. NO. TSC-02348-GA	
3RD ANGLE PROJECTION: 	INTERPRET GEOMETRIC TOLERANCING PER: ASME Y14.5	WEIGHT: 76.38 LBS.	