

ITEM NO.	PART NUMBER	DESCRIPTION	QTY.
10	TSC-00321-6	MUX CLAMP BASE ASSEMBLY, 4.61" PIPE TO NOSE	1
20	TSC-02593	CLAMP, 4.45 DIAMETER CABLE	1

REVISIONS				
REV.	DESCRIPTION	ECO #	DATE	APPROVED
A1	RELEASE		5/8/2019	
A2	ADDED FINAL WEIGHT	2019-059	6/3/2019	<i>CWB</i>

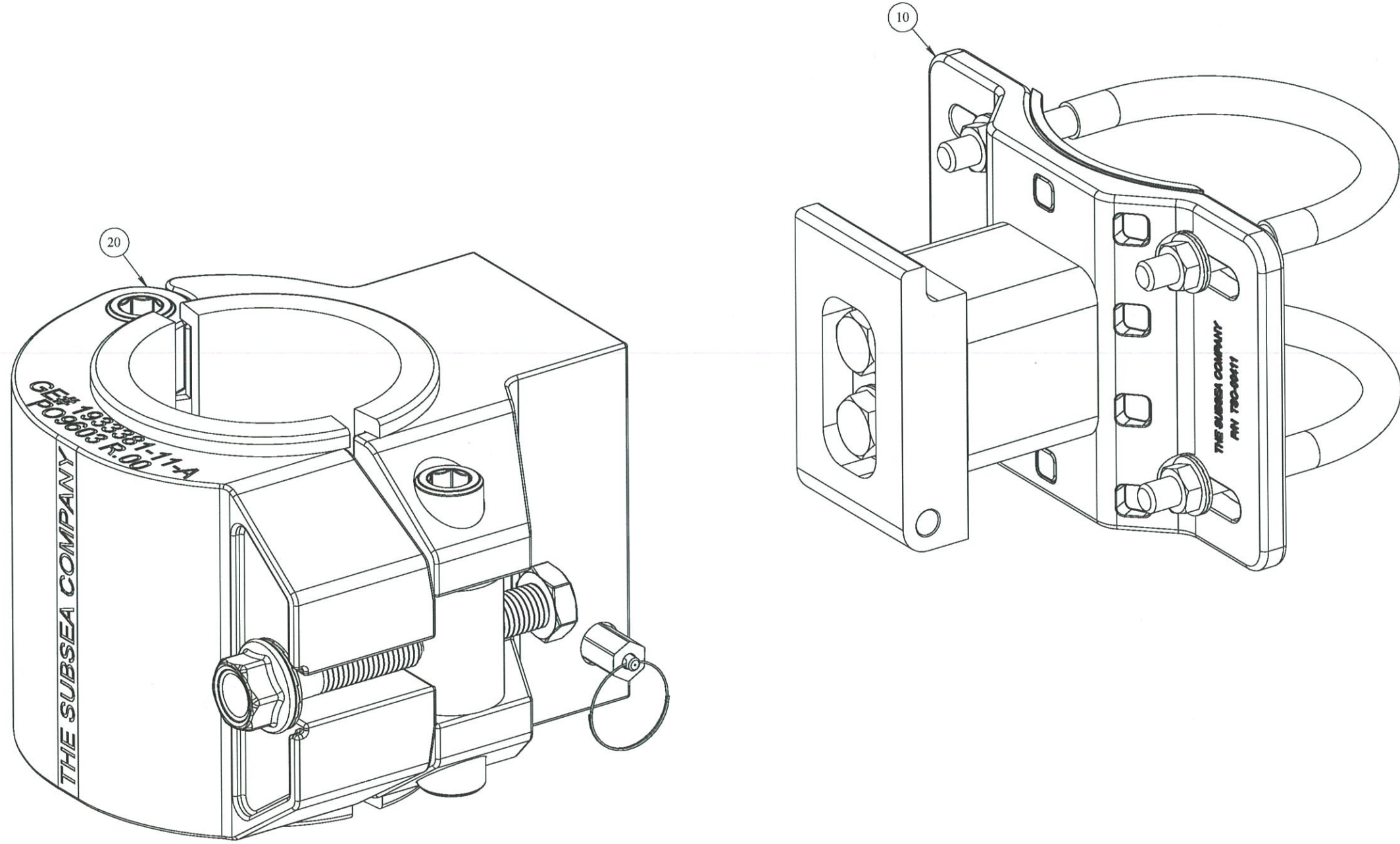

PROPRIETARY AND CONFIDENTIAL:
 THE INFORMATION CONTAINED IN THIS DRAWING IS THE SOLE PROPERTY OF THE SUBSEA COMPANY INC. ANY REPRODUCTION IN PART OR AS A WHOLE WITHOUT THE WRITTEN PERMISSION OF THE SUBSEA COMPANY INC IS PROHIBITED.

3RD ANGLE PROJECTION:

INTERPRET GEOMETRIC TOLERANCING PER: ASME Y14.5

WORKMANSHIP STANDARD PER W1 751-001

UNLESS OTHERWISE SPECIFIED:
 ALL DIMENSIONS ARE IN INCHES

WEIGHT: 38.00LBS.

	NAME	DATE
DRAWN	<i>GREC</i>	<i>6-3-19</i>
CHECKED	<i>AC</i>	<i>6-4-19</i>
APPROVED	<i>D3</i>	<i>6-4-19</i>

THE SUBSEA COMPANY INC		REV
SIZE	TITLE:	REV
B	CLAMP / ARM ASSEMBLY, 4.45 DIA, WITH 5.015 PIPE MOUNT	A2
DWG. NO. TSC-02565		SHEET 1 OF 1